

PART NUMBER: SMD-6262-03-DP

DESCRIPTION: 6.2.X6.2XHmm 6.2X6.2 SMD TACT SWITCH DUST PROOF



ROHS COMPLIANT

DUST PROOF

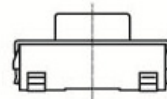
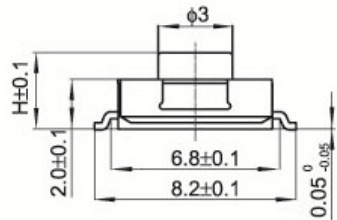
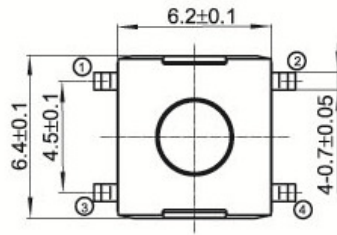

H
3.1
5.0

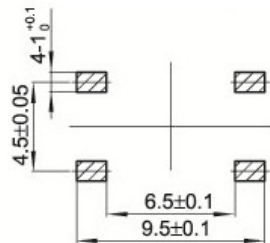
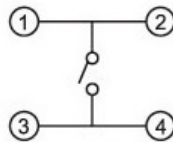

### SPECIFICATIONS

Items		Standard
Operating temperature range		-30°C to +85°C
Electrical performance	Rating	50mA. 12V DC
	Insulation resistance	100MΩ min. 100V DC
	Dielectric strength	250V AC for 1 min.
	Contact resistance	100mΩ max.
Durability	Lifetime	300,000 Cycles
Mechanical performance	Operating force	180gf 250gf
	Travel	0.25 ± 0.1mm

Dimensional tolerance +/- 0.2mm



PRAN ELECTRONICS PVT. LTD.  
INDIA.