

**RoHS
Compliant**

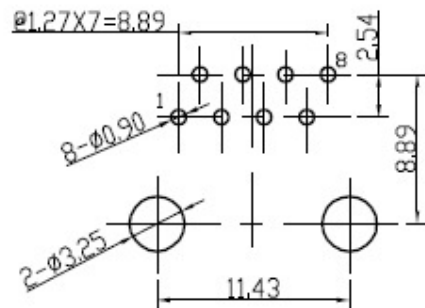
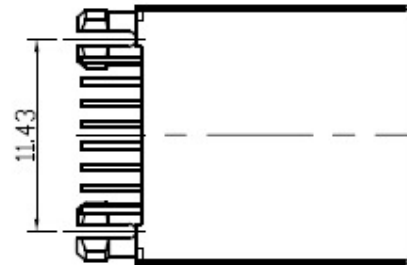
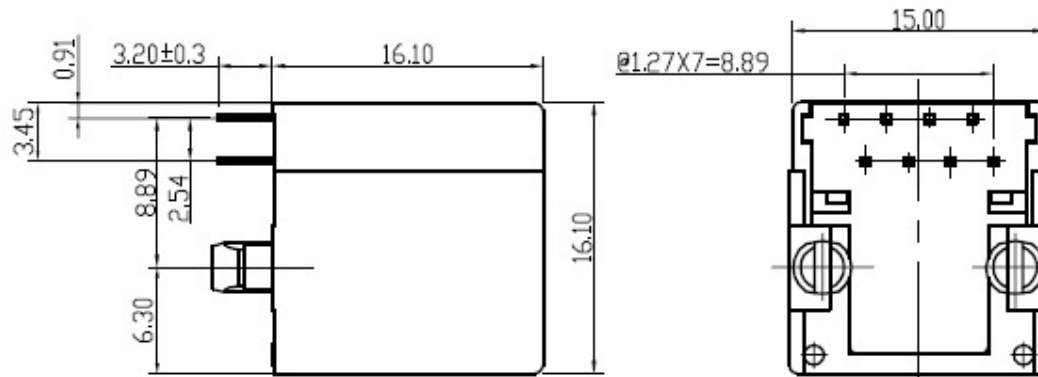
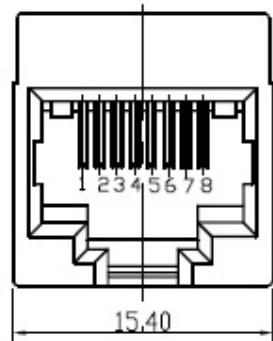

PC BOARD LAYOUT
THICKNESS=1.6MM

ENVIRONMENTAL:

1. STORAGE : -10°C~+40°C RELATIVE HUMIDITY<80%
2. OPERATION : -40°C~+85°C

MATES WITH MODULAR PLUG CONFORMING TO FCC PART 68, SUBPART F,
ROHS PART NUMBER:

ELECTRICAL:

- | | |
|--------------------------|-------------------------------|
| 1. VOLTAGE RATING | : 125 VAC RMS. |
| 2. CURRENT RATING | : 1.5 AMP. |
| 3. CONTACT RESISTANCE | : 45 MILLIOHMS MAX. |
| 4. INSULATION RESISTANCE | : 1000 MEGOHMS MIN @ 500 VDC. |
| 5. DIELECTRIC STRENGTH | : 1000 VAC RMS 60Hz, 1MIN. |

MECHANICAL:

- | | |
|----------------------------|---|
| 1. HOUSING&INSERT MATERIAL | : PBT/PA66 UL94V-0. |
| 2. CONTACT MATERIAL | : PHOSPHOR BRONZE T=0.35mm. |
| 3. PLATING | : 1: CONTACT AREA- SELECTIVE GOLD PLATING.
2: TAILS PLATING TIN OVER NICKEL. |
| 4. MATING/UNMATING FORCE | : 22N/2.27kg Max.. |
| 5. RETENTION STRENGTH | : 57.83N Min. . |
| 6. OPERATING LIFE | : 750 CYCLES MIN. |

Part Code: JP-T1-8P8C

Description: Top/Straight Entry RJ45 8P8C Connector

PRAN ELECTRONICS PVT. LTD.

INDIA

REV: 00 10/01/2008